

Chair Smith and Members of the Senate Judicial Proceedings Committee:

Thank you for the opportunity to testify today in support of this legislation. My name is Greg Lickenbrock, and I am the Senior Firearms Analyst for Everytown for Gun Safety. Before joining Everytown, I spent a decade working in the gun industry as a magazine editor. I tested hundreds of firearms, attended media events and training courses, and met people working at every level of the firearms industry. I've also worked extensively with Glock and its products.

Federal and state law prohibit civilians from owning machine guns and the parts used to create them. But "switches" have made it extremely easy for people to convert Glock-style pistols into machine guns that can fire 20 rounds per second. These switches are tiny, easy to 3D print, and difficult for police to detect and intercept.

Glock-style pistols are uniquely easy to convert with switches — it takes less than a minute to install one — because they use cross-shaped (or "cruciform") trigger bars that provide surface area for a switch to contact. Each time the gun's slide returns forward, the switch hits the trigger bar and pushes it downward, causing the gun to fire. As long as the shooter depresses the trigger and the gun has ammunition, it will continue firing.

This kind of rapid fire has already devastated many communities, as guns with switches have been used in at least 20 mass shootings across the U.S., and they've also been recovered all over Maryland in connection with criminal activity.

This problem is fixable, however. The only pistols compatible with switches are those that use Glock-style trigger bars, including Glocks and Glock clones designed to capitalize on the company's expired patents and market share — like the Ruger RXM that debuted in December 2024 and pistols made by several smaller companies.

Other pistols made by the largest manufacturers — including Smith & Wesson, Sig Sauer, Springfield, and others — are incompatible with switches because their trigger bars are broken into smaller, disparate components that are shielded from interference.

That is why I believe this bill offers a smart, targeted approach to solving this problem and saving lives. Under this bill, gun dealers won't be able to sell to the public guns that use cruciform trigger bars and can be modified with switches using common household tools. At the same time, the bill would not touch most of the handgun market, the guns people already own, or sales to law enforcement. I respectfully ask you to stand up for public safety and pass this bill. Thank you.

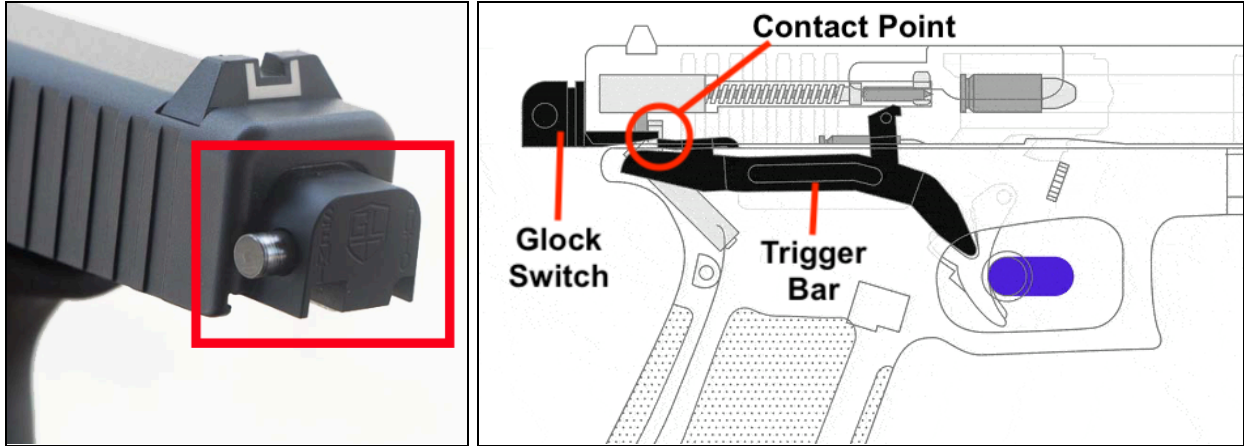

A Glock switch attaches to the rear of a Glock slide (left) and contacts the trigger bar (right).

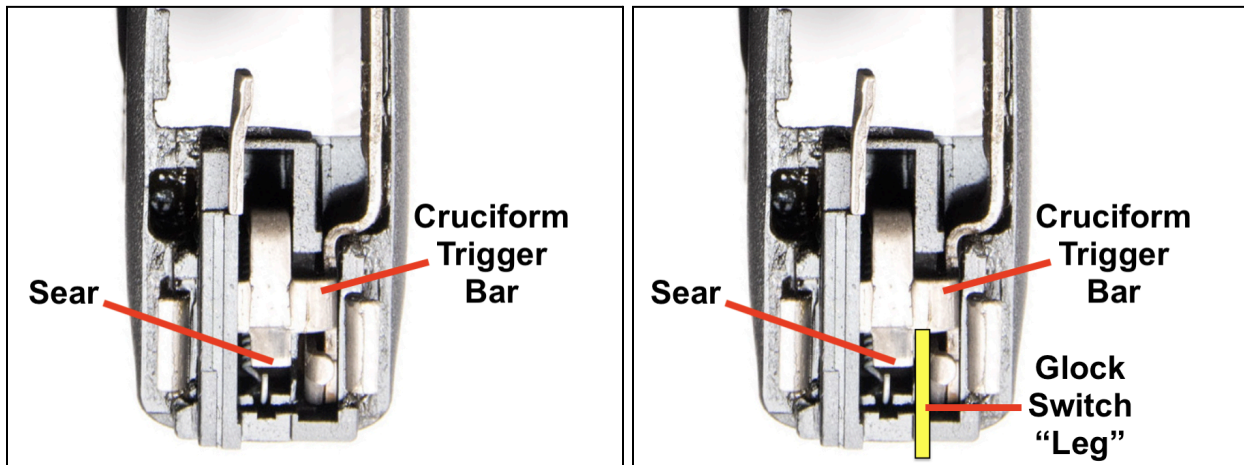

These top-down views show a Glock's cross-shaped (or "cruciform") trigger bar and where a Glock switch (shown in yellow) pushes the trigger bar downward, causing the gun to fire.

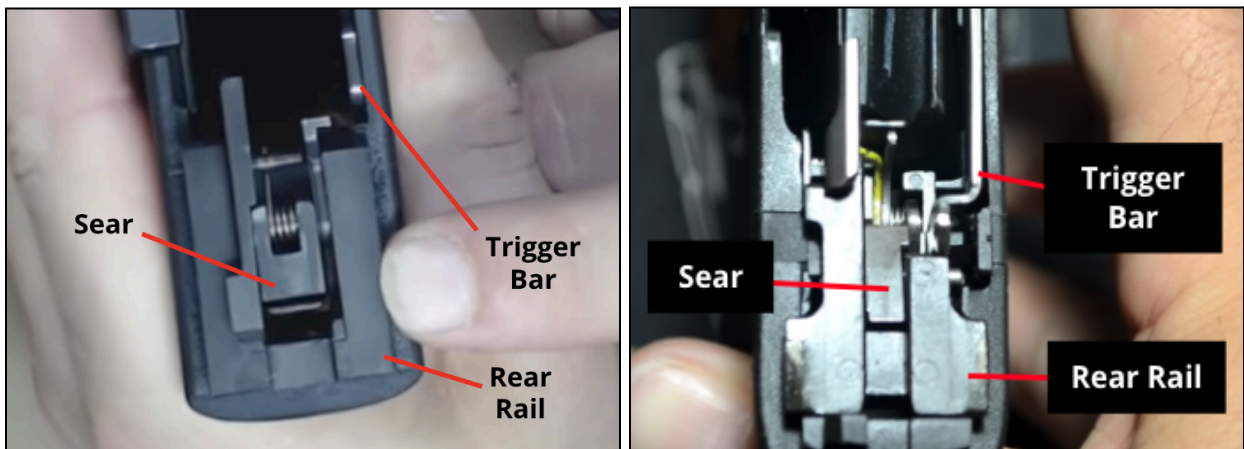

Adding a switch to Springfield XD (left) or Smith & Wesson M&P (right) pistols would require extensive modifications and engineering.